

Unable to logon to server ENSEMBLE.

Published on InterSystems Developer Community (<https://community.intersystems.com>)

Question

[Harshdeep Acharya](#) · Jun 6, 2022

Unable to logon to server ENSEMBLE.

Hi Team,

"Unable to logon to Server Ensemble" also I have don't have access to Ensemble studio and Management portal also, on Ensemble Server (2015.2.0.664.1) Production Server.

PFA error screenshot for your reference.

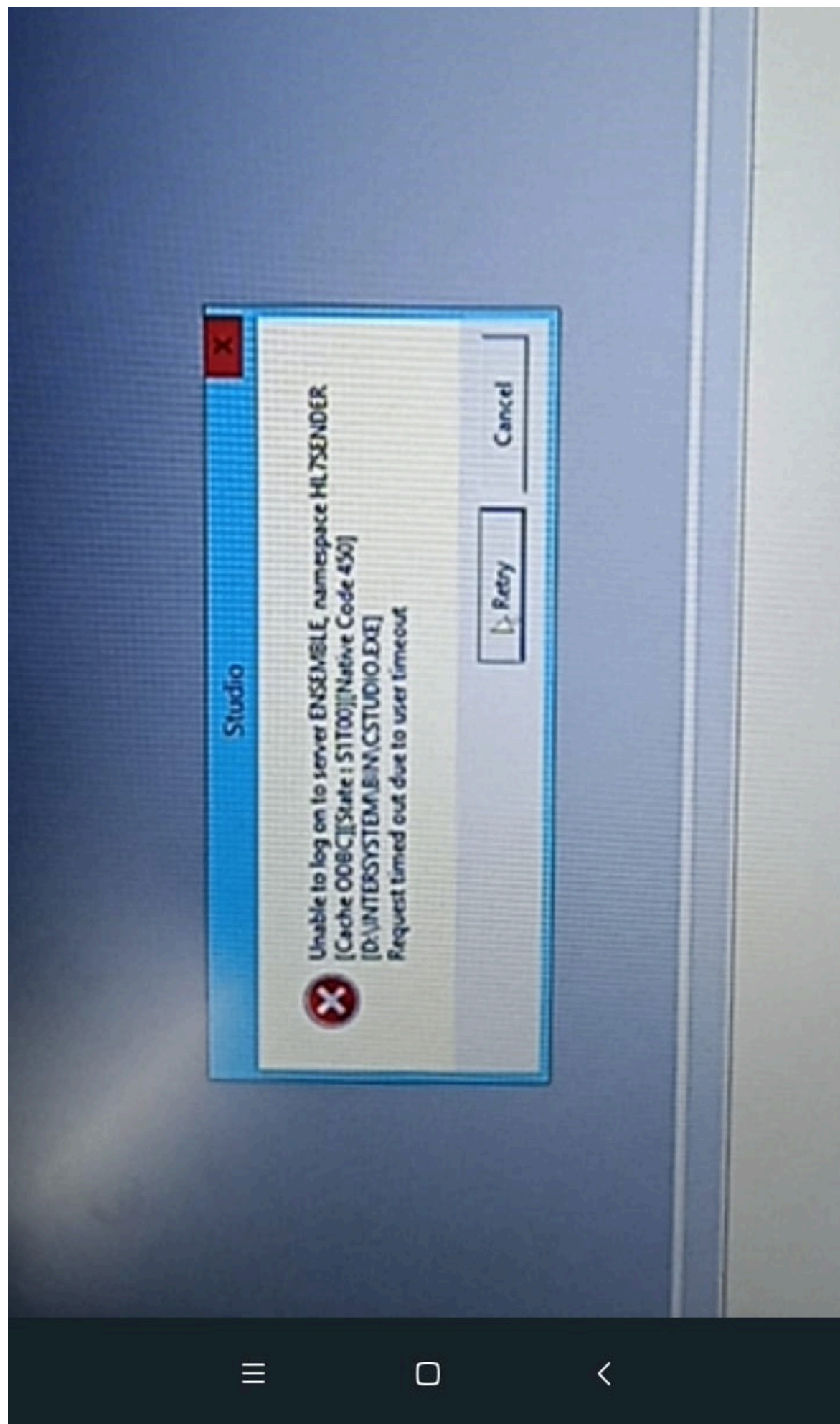

Unable to logon to server ENSEMBLE.

Published on InterSystems Developer Community (<https://community.intersystems.com>)

Thanks and Regards,

Harshdeep Acharya

[#Management Portal](#) [#Studio](#) [#Ensemble](#)

Product version: Ensemble 2015.1

Source URL: <https://community.intersystems.com/post/unable-logon-server-ensemble>